



Power Bridge Rectifiers

SKD 50

Features

- Isolated metal case with screw terminals
- Blocking voltage up to 1600 V
- High surge current
- Easy chassis mounting

Typical Applications

- Three phase rectifiers for power supplies
- Input rectifiers for variable frequency drives
- Rectifiers for DC motor field supplies
- Battery charger rectifiers
- Recommended snubber network:
RC: 0.1 μ F, 50 Ω ($P_R = 1$ W)

- 1) Freely suspended or mounted on an insulator
- 2) Mounted on a painted metal sheet of min. 250 x 250 x 1 mm

| V_{RSM}, V_{RRM} V | V_{VRMS} V | $I_D = 50$ A ($T_c = 92$ °C) Types | C_{max} μ F | R_{min} Ω |
|-------------------------|-----------------|--|----------------------|-----------------------|
| 200 | | SKD 50/02A3 | | 0,1 |
| 400 | | SKD 50/04A3 | | 0,2 |
| 800 | | SKD 50/08A3 | | 0,4 |
| 1200 | | SKD 50/12A3 | | 0,6 |
| 1400 | | SKD 50/14A3 | | 0,7 |
| 1600 | | SKD 50/16A3 | | 0,8 |

| Symbol | Conditions | Values | Units |
|---------------|--|----------------|------------------|
| I_D | $T_a = 45$ °C, isolated ¹⁾ | 10 | A |
| | $T_a = 45$ °C, chassis ²⁾ | 22 | A |
| I_{DCL} | $T_a = 45$ °C, isolated ¹⁾ | 10 | A |
| | $T_a = 45$ °C, chassis ²⁾ | 22 | A |
| | $T_a = 35$ °C, P1A/120 F | 60 | A |
| I_{FSM} | $T_{vj} = 25$ °C, 10 ms | 750 | A |
| | $T_{vj} = 150$ °C, 10 ms | 600 | A |
| i^2t | $T_{vj} = 25$ °C, 8,3 ... 10 ms | 2800 | A ² s |
| | $T_{vj} = 150$ °C, 8,3 ... 10 ms | 1800 | A ² s |
| V_F | $T_{vj} = 25$ °C, $I_F = 150$ A | max. 1,6 | V |
| $V_{(TO)}$ | $T_{vj} = 150$ °C | 0,85 | V |
| r_T | $T_{vj} = 150$ °C | 8 | m Ω |
| I_{RD} | $T_{vj} = 25$ °C, $V_{RD} = V_{RRM}$ | 1000 | μ A |
| I_{RD} | $T_{vj} = 150$ °C, $V_{RD} = V_{RRM}$ | 10 | mA |
| t_{rr} | $T_{vj} = 25$ °C | 10 | μ s |
| f_G | | 2000 | Hz |
| $R_{th(j-a)}$ | isolated ¹⁾ | 5,5 | K/W |
| | chassis ²⁾ | 2,3 | K/W |
| $R_{th(j-c)}$ | total | 0,45 | K/W |
| $R_{th(c-s)}$ | total | 0,06 | K/W |
| T_{vj} | | - 40 ... + 150 | °C |
| T_{stg} | | - 55 ... + 150 | °C |
| V_{isol} | a. c. 50 ... 60 Hz; r.m.s.; 1 s / 1 min. | 3000 / 2500 | V~ |
| M_s | to heatsink | 5 \pm 15 % | Nm |
| M_t | to terminals | 3 \pm 15 % | Nm |
| a | | 5 * 9,81 | m/s ² |
| m | | 250 | g |
| F_u | | 50 | A |
| Case | | G 15 | |

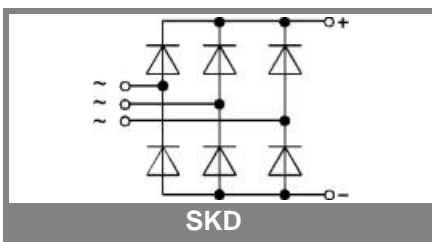

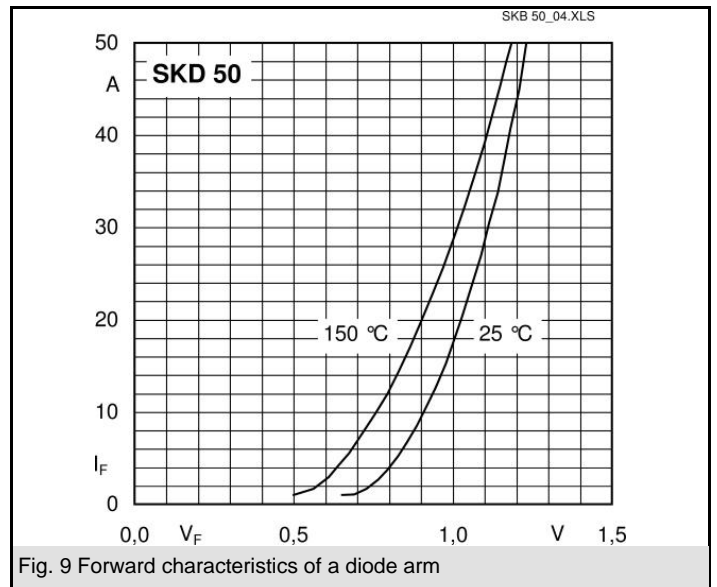
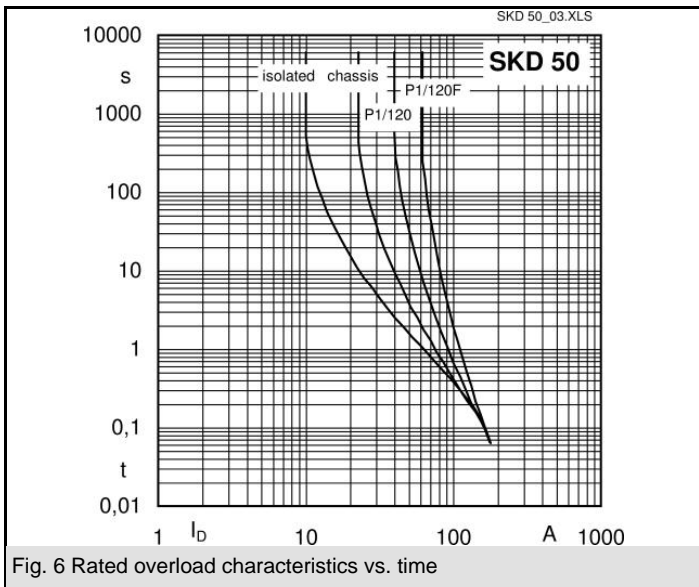
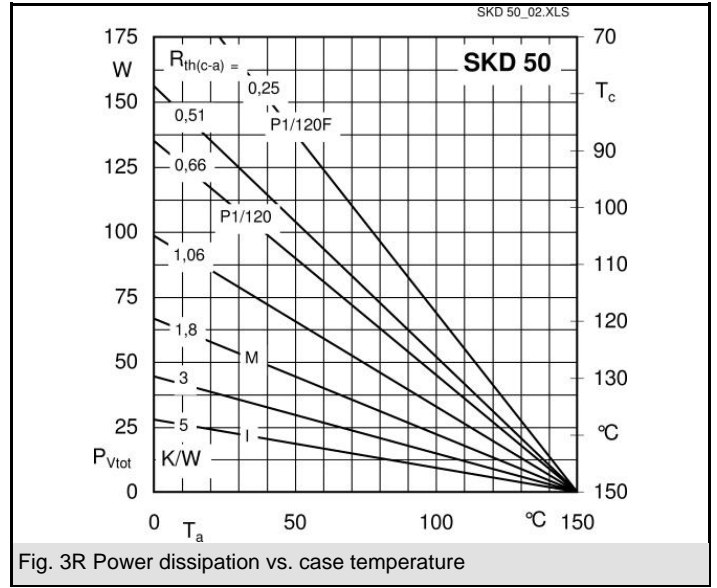
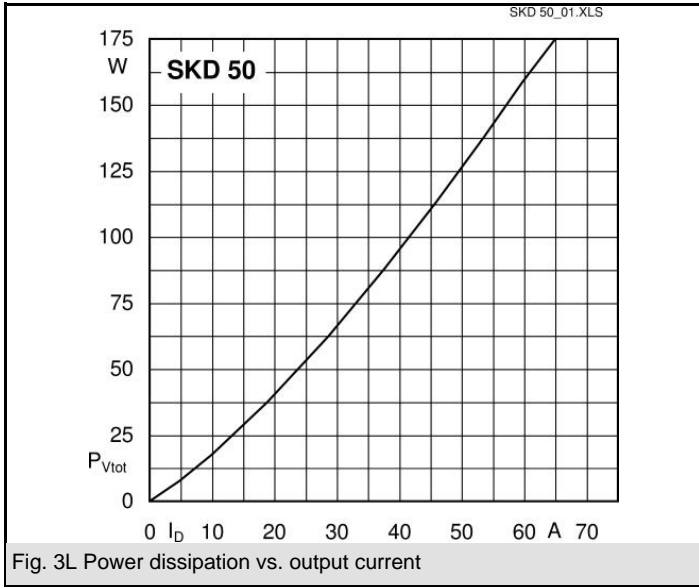

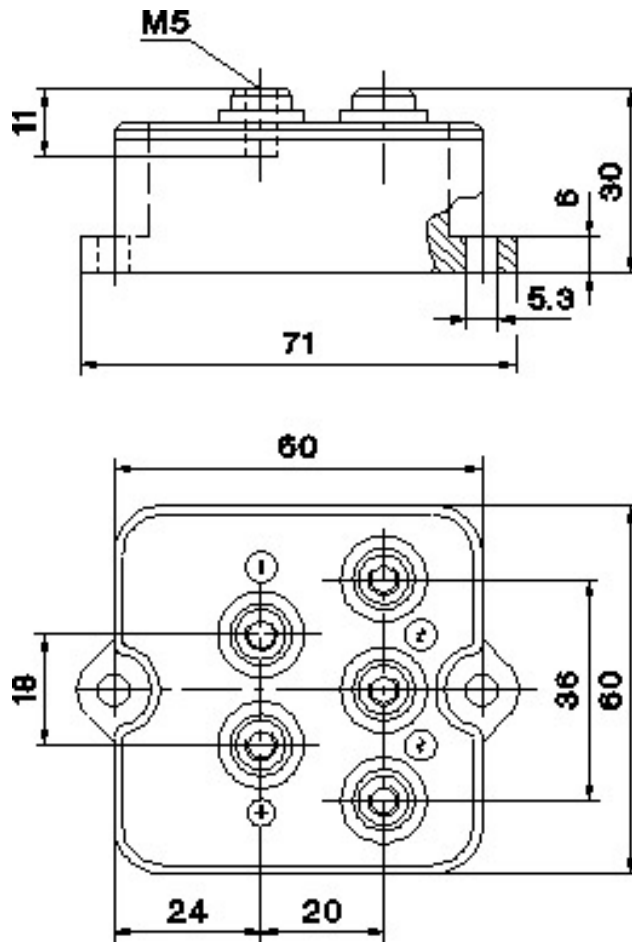

Case G 15

This technical information specifies semiconductor devices but promises no characteristics. No warranty or guarantee expressed or implied is made regarding delivery, performance or suitability.